

Silencer

With throttle valves

Brass

When compressed air escapes into the atmosphere, it produces noise. This can be prevented by installing a silencer.

These dampers are provided with a porous material. The air flows through the material and is distributed, reducing the noise level.

Type:

Cone-shaped throttle valve with silencer

Application:

Choke exhaust air behind a control valve

Benefits:

- Cheap speed control including noise reduction

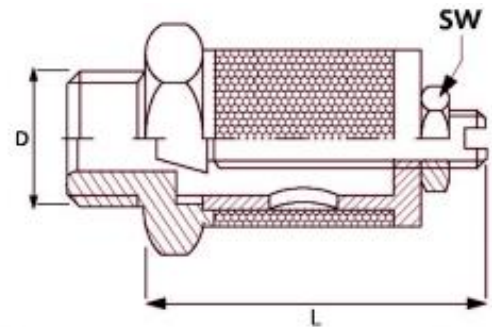

ARTICLE NUMBER	Thread (A)	Length	SW
CM5B	M5	13mm	6
CM18B	G 1/8"	22mm	10
CM14B	G 1/4"	22mm	10
CM38B	G 3/8"	25mm	10
CM12B	G 1/2"	26mm	10
CM34B	G 3/4"	32mm	13
CM10B	G 1"	32mm	13