

When compressed air escapes into the atmosphere, it creates noise.  
This can be prevented by installing a silencer.  
These dampers are made of a porous material. The air flows  
through the material and distributed, reducing the noise level.

Silencer throttle valves with knurled screw

Type: Cone-shaped butterfly valve with silencer, spring-loaded brake

Application:

Throttling of the exhaust air behind a control valve

Services:

- Favorable speed control including sound insulation

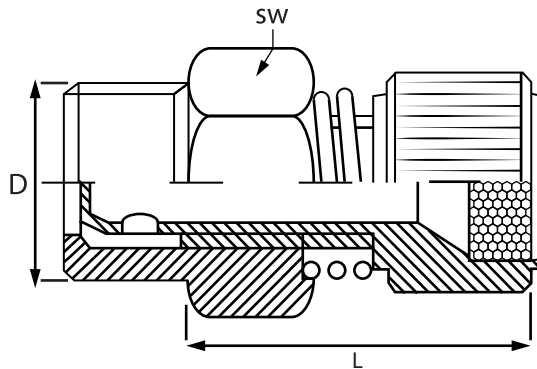

Art. code	Thread	Wrench size	<i>min.</i>	Length (L)	<i>max.</i>
CM18BKS	G 1/8 "	13 mm	20 mm		23 mm
CM14BKS	G 1/4 "	15 mm	22 mm		29 mm
CM38BKS	G 3/8 "	18 mm	25 mm		28 mm
CM12BKS	G 1/2 "	22 mm	26 mm		29 mm
CM34BKS	G 3/4 "	30 mm	32 mm		37 mm
CM10BKS	G 1 "	36 mm	32 mm		37 mm