

## Technical drawings

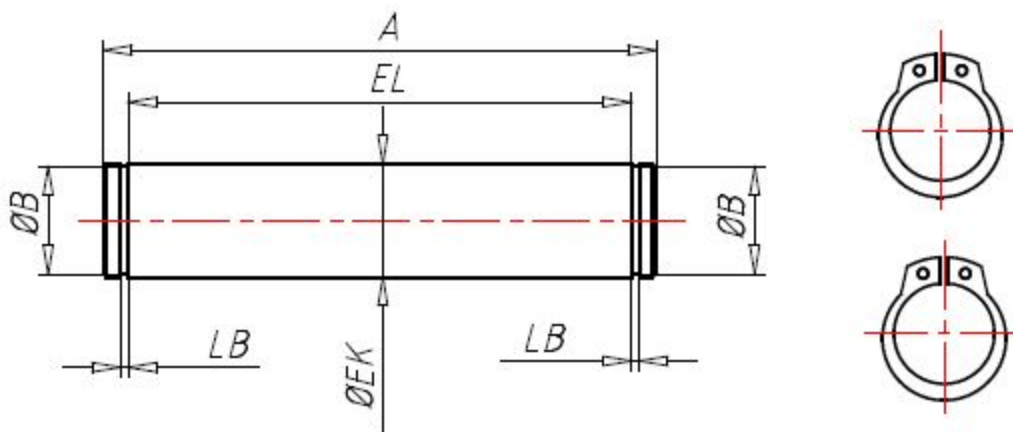

MAT (Material)	Zinc coated steel
PCG (Packaging)	s - single packaging
DI ( $\varnothing$ / mm)	50
EK ( $\varnothing$ EK / mm)	12
EL (EL / mm)	61
B ( $\varnothing$ B / mm)	11.5
LB (LB / mm)	1.1
A (A / mm)	68