

When compressed air escapes into the atmosphere, it creates noise.
This can be prevented by installing a silencer.
These dampers are made of a porous material. The air flows
through the material and distributed, reducing the noise level.

Silencer throttle valves with knurled screw

Type: Cone-shaped butterfly valve with silencer, spring-loaded brake

Application:

Throttling of the exhaust air behind a control valve

Services:

- Favorable speed control including sound insulation

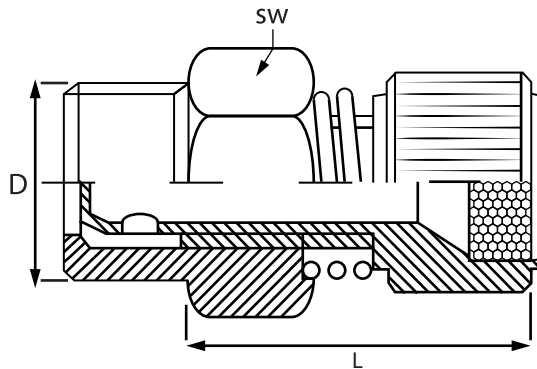

| Art. code | Thread | Wrench size | <i>min.</i> | Length (L) | <i>max.</i> |
|-----------|---------|-------------|-------------|------------|-------------|
| CM18BKS | G 1/8 " | 13 mm | 20 mm | | 23 mm |
| CM14BKS | G 1/4 " | 15 mm | 22 mm | | 29 mm |
| CM38BKS | G 3/8 " | 18 mm | 25 mm | | 28 mm |
| CM12BKS | G 1/2 " | 22 mm | 26 mm | | 29 mm |
| CM34BKS | G 3/4 " | 30 mm | 32 mm | | 37 mm |
| CM10BKS | G 1 " | 36 mm | 32 mm | | 37 mm |