



Symbol



Specification

Port size	M5×0.8
Medium	Air
Operating pressure range (*)	0.05~1 MPa
Proof pressure	1.5 MPa
Regulated pressure range	0.05~0.7 MPa
Ambient temperature	- 5~+60°C (No freezing)
Filter element	Standard: 5µm, Option: 40µm
Drain capacity	3.5 cm ³
Weight	130 g

*Standard unit contains semi-auto-drain function when operating pressure below 0.05 MPa.

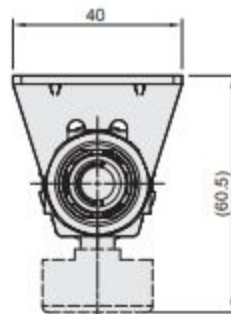

Panel mounting hole

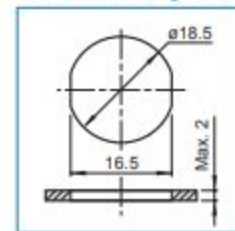

Flow feature

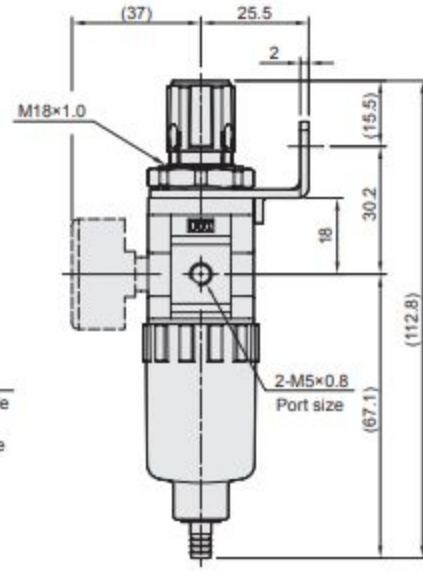
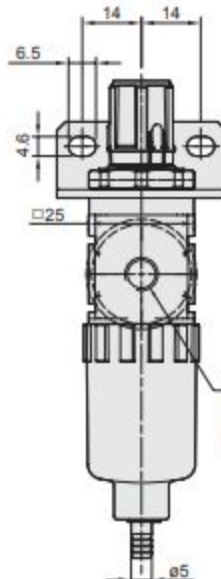
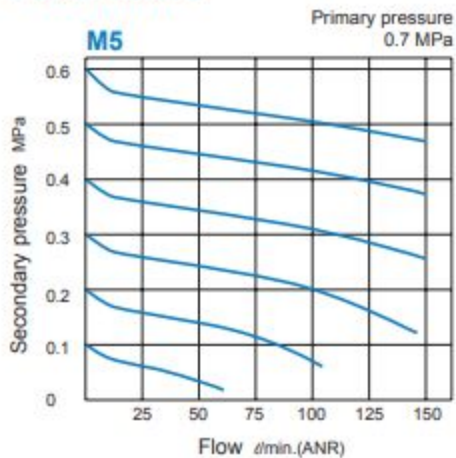



Symbol



Specification

Bore No.	6A	8A
Port size	1/8	1/4
Medium	Air	
Operating pressure range (*)	0.05~1 MPa	
Proof pressure	1.5 MPa	
Regulated pressure range	Standard: 0.05~0.85 MPa	
Ambient temperature	- 5~+60°C (No freezing)	
Filter element	Standard: 40µm, Option: 5 µm	
Drain capacity	25 cm ³	
Weight	226 g	

* Standard unit contains semi-auto-drain function when operating pressure below 0.05 MPa.

Flow feature

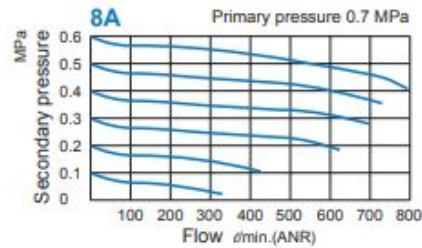
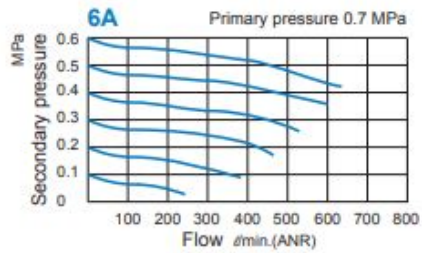

L type bracket

