

# Valves

## Pneumatically Actuated Valves

### 3/2-way valves

### In-line valves

### P 320 302

Pilot actuated valve | bistable | all ports on one side

HAFNER

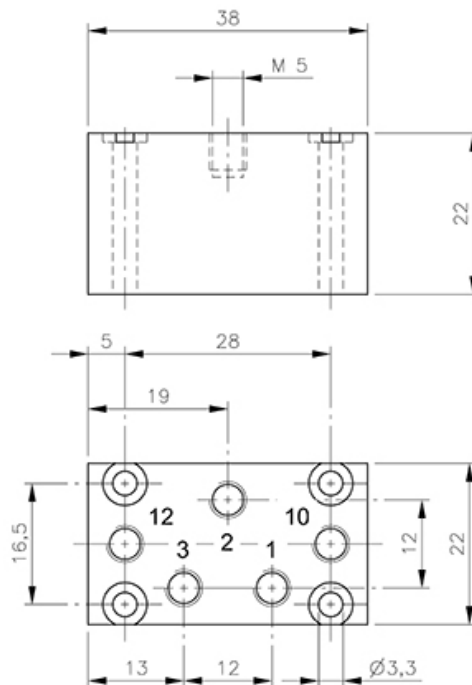
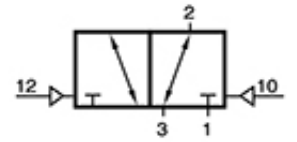

**Specifications**

Port size	M 5
Air flow	180 l/min
Operating pressure	1...10 bar
Actuating pressure	2,5...10 bar
Size of actuation port	M 5
Function	Double pilot

[www.hafner-pneumatika.com](http://www.hafner-pneumatika.com)