

ZUIGNAPPEN
VACUUM CUPS

DIEPE
DEEP

VSA



ZUIGNAPPEN
VACUUM CUPS

ZUIGNAPPEN
VACUUM CUPS

GESCHIKT VOOR
SUITABLE FOR

Bolvormige oppervlakte
Spherical surfaces

Gebogen oppervlakte
Curved surfaces

VOORDELEN
ADVANTAGES

Diepe holle vorm
Deep concave shape

Stevige structuur
Sturdy structure

Geïntegreerde fitting
Integrated fitting

Ø 31

Ø 46

Ø 63

Ø 85

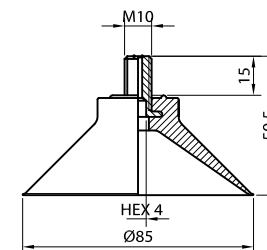
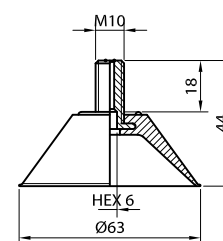
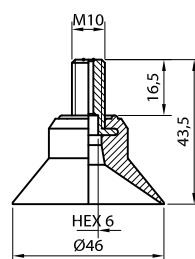
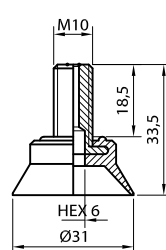
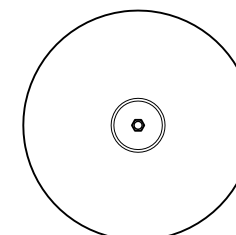
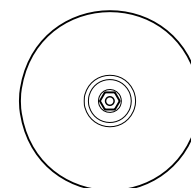
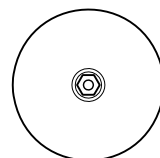
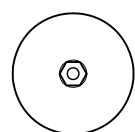

SPECIFICATIES · CHARACTERISTICS

Ø Onbelast / Ø Belast <i>Ø unloaded / Ø loaded</i>	[mm]
Minimale buig radius <i>Minimum curve radius</i>	[mm]
Maximale slag <i>Maximum stroke</i>	[mm]
Volume <i>Volume</i>	[cm ³]
Gewicht <i>Weight</i>	[g]
Kracht -0,4 bar <i>Force at -0,4 bar</i>	[Kgf]
Kracht -0,6 bar <i>Force at -0,6 bar</i>	[Kgf]
Kracht -0,8 bar <i>Force at -0,8 bar</i>	[Kgf]
Kracht -0,9 bar <i>Force at -0,9 bar</i>	[Kgf]

31 / 36,5	46 / 49	63 / 72	85 / 91,5
15,5	25	22,5	45
5	7,5	9,5	14,5
5	12	29	58
16	25	28	48
2,02	5,16	9,32	15,2
3,13	7,22	12,6	20,7
4,21	9,11	15,4	24,9
4,73	10,1	16,6	26,7

BESTELLEN · HOW TO ORDER

● Nitrile zuignap met geïntegreerde fitting
Nitrile vacuum cup with integrated fitting

VSA31NIT	VSA46NIT	VSA63NIT	VSA85NIT
----------	----------	----------	----------

ZUIGNAPPEN
VACUUM CUPS

DIEPE
DEEP

VSA



SPECIFICATIES · CHARACTERISTICS

Ø Onbelast / Ø Belast	Ø unloaded / Ø loaded	[mm]
Minimale buig radius	Minimum curve radius	[mm]
Maximale slag	Maximum stroke	[mm]
Volume	Volume	[cm ³]
Gewicht	Weight	[g]
Kracht -0,4 bar	Force at -0,4 bar	[Kgf]
Kracht -0,6 bar	Force at -0,6 bar	[Kgf]
Kracht -0,8 bar	Force at -0,8 bar	[Kgf]
Kracht -0,9 bar	Force at -0,9 bar	[Kgf]

BESTELLEN · HOW TO ORDER

● Nitrile zuignap met geïntegreerde fitting
Nitrile / ecun vacuum cup with integrated fitting

GESCHIKT VOOR
SUITABLE FOR

Bolvormige oppervlakte
Spherical surfaces

Gebogen oppervlakte
Curved surfaces

VOORDELEN
ADVANTAGES

Diepe holle vorm
Deep concave shape

Stevige structuur
Sturdy structure

Geïntegreerde fitting
Integrated fitting

Ø 45

Ø 45 M14

Ø 62

Ø 80

Ø 115

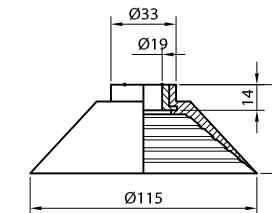
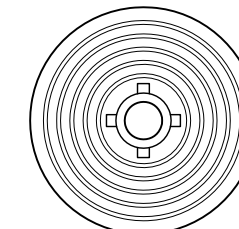
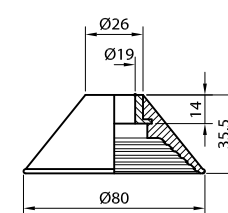
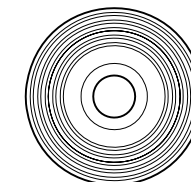
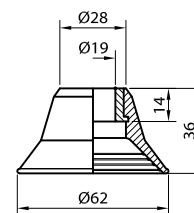
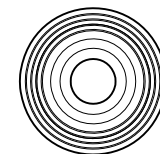
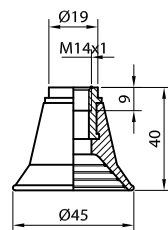
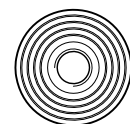
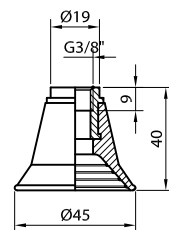
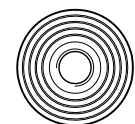

45 / 50	45 / 50	62 / 71,5	80 / 90	115 / 129
20	20	27,5	35	55
7	7	10	15,5	21,5
15	15	38	66	139
26	26	35	44	103
5,01	5,01	9,69	15,2	30,8
7,13	7,13	14,0	21,4	42,1
9,35	9,35	17,3	25,8	52,0
10,5	10,5	18,9	28,4	56,7
VSA45NIT	VSA45NIT	VSA62ECU	VSA80ECU	VSA115ECU